

Multi-axis controller V11



The multi-axis controller V11 is a robust switching device for crane and hoisting applications. The modular design enables the switching device to be used universally. The V11 is resistant to oil, maritime conditions e.g. offshore / vessels, UV radiation typically from the sun.



1

Technical data

Mechanical life	10 million operating cycles
Operation temperature	-40°C to +60°C
Degree of protection	IP54 front

	V11L	S5	P	T	Example				
					- 01 Z P	+ 03A R	- A05 P324	+ A110	- X
Basic unit	[Shaded]								
V11L 2-axis left	[Shaded]								
Control-handle extended	[Shaded]								
S5 -20mm	[Shaded]								
Gate	[Shaded]								
P Cross gate	[Shaded]								
Grip / palm grip	[Shaded]								
T Dead man	[Shaded]								
Axis 1 (direction 1-2)	[Shaded]								
01 2 contacts (2A 250V AC15)	[Shaded]								
Z Spring return	[Shaded]								
P Potentiometer	[Shaded]								
Axis 2 (direction 3-4)	[Shaded]								
03A 6 contacts (4A 250V AC15)	[Shaded]								
R Friction brake	[Shaded]								
Description axis 1 (direction 1-2)	[Shaded]								
A05 Arrangement MS21	[Shaded]								
P324 Potentiometer T365 2x5kOhm	[Shaded]								
Description axis 2 (direction 3-4)	[Shaded]								
A110 Arrangement MS24-0	[Shaded]								
Special model	[Shaded]								
X Special / customer specified	[Shaded]								

Combination possibilities with our handles



V11L S5 P T - 01 Z P + 03A R P - A05 P324 + A110 P325 - X

Basic unit

- V11L 2-axis left
- V11R 2-axis right
- V11.1L 1-axis left
- V11.1R 1-axis right

Control-handle extended*

- Standard 120mm
- S5 -20mm
- S8 +20mm

*Only available in combination with handle!

Gate

- P Cross gate
- P X Special gate

Grip / palm grip

- Knob (included in basic unit!)
- M Mechanical zero interlock
- MN Mechanical zero interlock (push down)
- T Dead man
- H Signal button
- D Push button
- DV Flush push button
- B... Palm grip B... (see page palm grip 147)

Identification of the installation variants with switching directions:

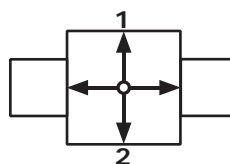

V11.1

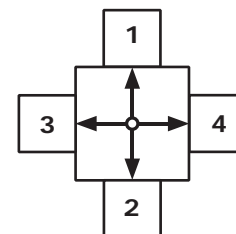

V11

V11L S5 P T - 01 Z P + 03A R P - A05 P324 + A110 P325 - X

Axis 1: direction 1-2 left / direction 5-6 right			
(Standard contacts gold-plated 2A 250V AC15)			
01	<input type="checkbox"/>	2 contacts	Standard contact - arrangement see page 131
02	<input type="checkbox"/>	4 contacts	e.g.
03	<input type="checkbox"/>	6 contacts	A980 MS00 A05 MS21 A0500 MS21-00 A110 MS24-0
<input type="checkbox"/>		A = Silver contacts (4A 250V AC15)	A99 contact - arrangement according customer request
Z	Spring return		
R	Friction brake		
(P)	Possibility of mounting potentiometer and encoder (Gessmann-types)		
P	Potentiometer	P324 T365 2x5kOhm	I max. 1mA
		P325 T365 2x10kOhm	I max. 1mA
<i>More potentiometers on request!</i>			
C	Encoder	C... Encoder see page 137	

If both axis identical, it's enough to describe one axis!

example: ...A05P324 + A05P324 => A05P324

V11L S5 P T - 01 Z P + 03A R P - A05 P324 + A110 P325 - X

Axis 2: direction 3-4 left / direction 7-8 right			
(Standard contacts gold-plated 2A 250V AC15)			
01	<input type="checkbox"/>	2 contacts (2A 250V AC15)	Standard contact - arrangement see page 131
02	<input type="checkbox"/>	4 contacts (2A 250V AC15)	z.B.
03	<input type="checkbox"/>	6 contacts (2A 250V AC15)	A980 MS00 A05 MS21 A0500 MS21-00 A110 MS24-0
<input type="checkbox"/>		A = Silver contacts (4A 250V AC15)	A99 contact - arrangement according customer request
Z	Spring return		
R	Friction brake		
(P)	Possibility of mounting potentiometer and encoder (Gessmann-types)		
P	Potentiometer	P324 T365 2x5kOhm	I max. 1mA
		P325 T365 2x10kOhm	I max. 1mA
<i>More potentiometers on request!</i>			
C	Encoder	C... Encoder see page 137	

V11L S5 P T - 01 Z P + 03A R P - A05 P324 + A110 P325 - X

Special model	
X	Special / customer specified

Attachments	
<input type="checkbox"/>	Indicating labels
<input type="checkbox"/>	Indicating labels with engraving

Technical details may vary based on configuration or application! Technical data subject to change without notice!

Multi-axis controller V11

T = Dead man's button
H = Signalbutton
M = Latch for mechanical zero interlock

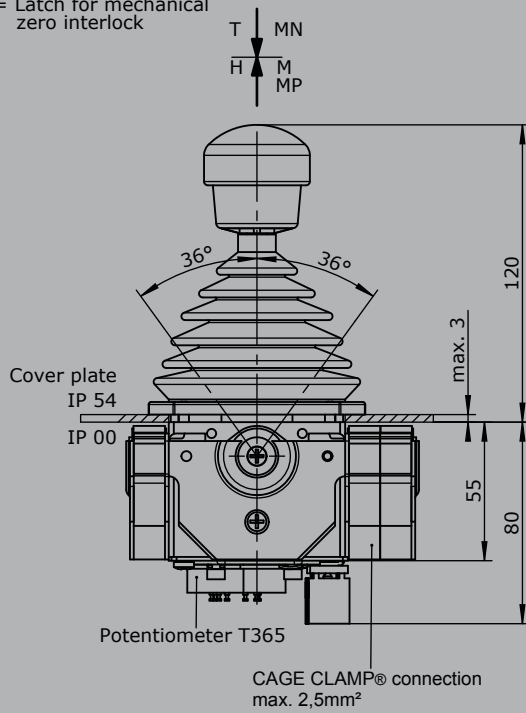

Knob solid
D= Push button

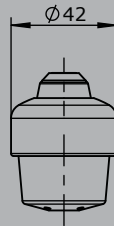

Palm grip B1

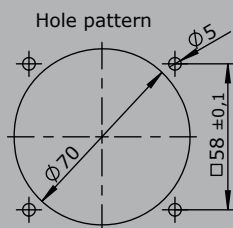
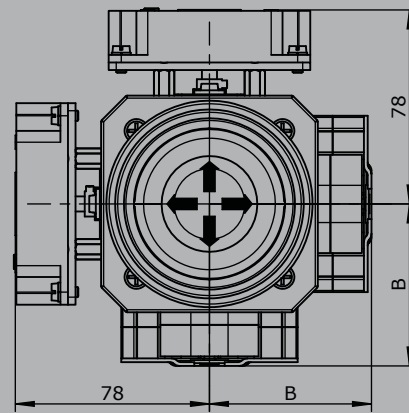
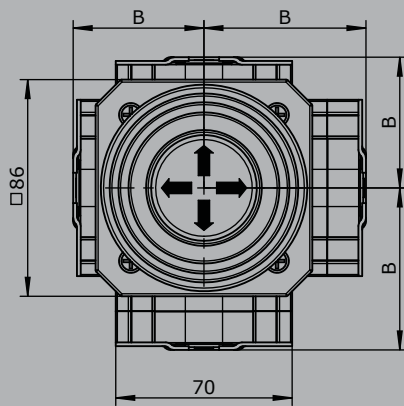
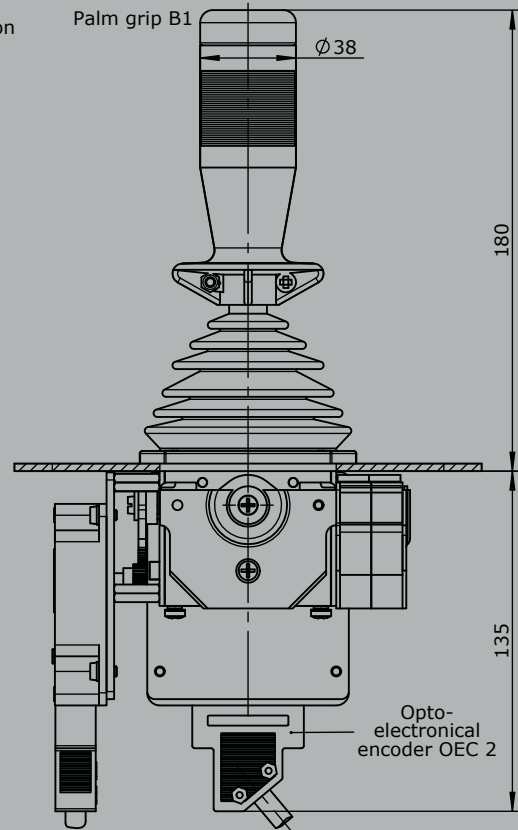

Type	No. of contacts	Dim. B
01	2	51
02	4	64
03	6	76